

Transfer or duplication of this document as well as the utilization or communication of its contents are prohibited unless written authorization in printed characters will be taken for compensation. All rights reserved for patent, utility model or designs registrations. 非经书面授权，否则禁止转让、复制、利用、交流本文件的内容，否则将承担法律责任。本公司保留对涉及发明、实用新型和外观设计的所有权利。

未注公差/General tolerances(mm)											0.1/10		
0 ~ 3	>3 ~ 6	>6 ~ 10	>10 ~ 18	>18 ~ 30	>30 ~ 50	>50 ~ 80	>80 ~ 120	>120 ~ 180	>180 ~ 250	>250 ~ 315		>315 ~ 400	>400 ~ 500
±0.12	±0.18	±0.22	±0.26	±0.31	±0.37	±0.57	±0.80	±0.93	±1.05	±1.15	±1.60	±2.20	±2.50

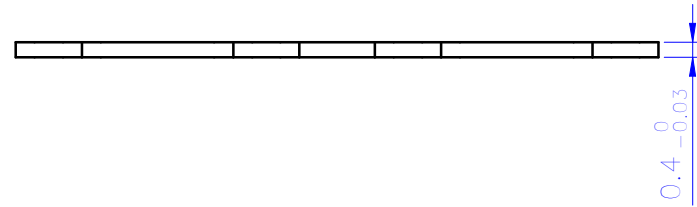
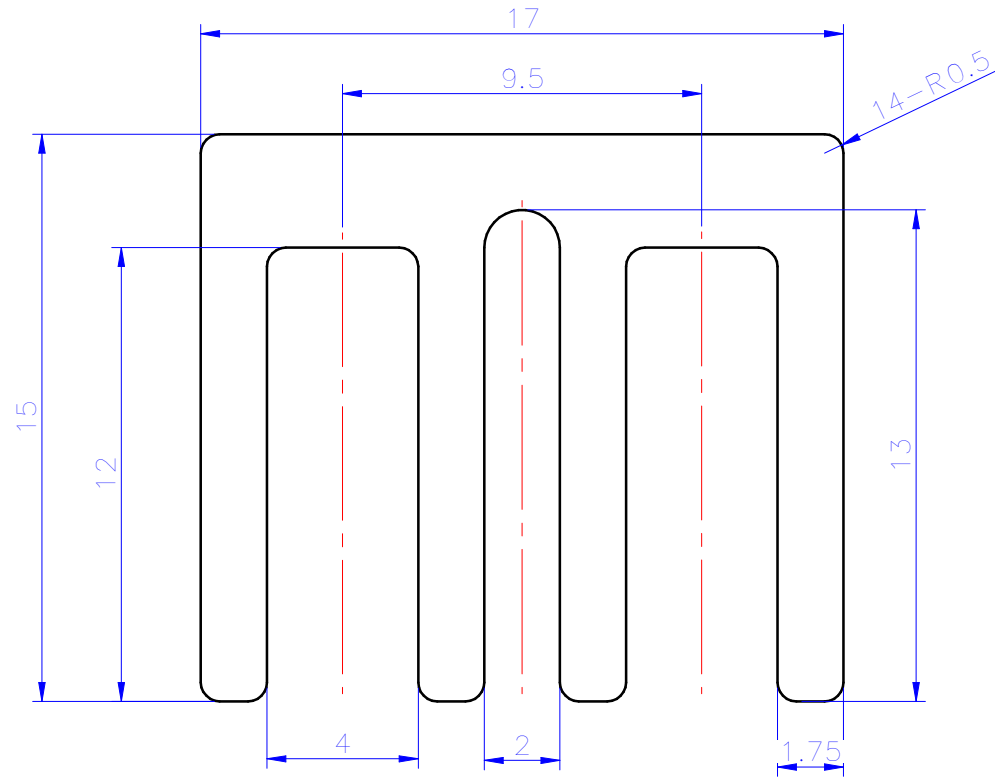

1	Pin Header	Copper alloy	Sn Plated
ITEM	NAME OF PART	MATERIAL	NOTES

符合 RoHS 环保要求 / Conform to RoHS Yes

		MATERIAL: /	SURFACE/COLOR: /	
APPD: / CHKD: /		MAT. NO./REV: 10900000035-1 / 00	MAT STATUS: 批量	
DRFT: 谢晓栋 2022-7-14		NAME: K24-00A(H)		
DRAWING NO. 200044924		TYPE: CUSTOMER DRAWING		DRAWING STATUS: /
SCALE: 5:1		SHEET: 1/1		

00	/	/	谢晓栋	2022-7-14
REV	ECN	DESCRIPTION	DRFT	DATE