

[Female]

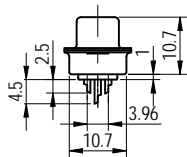

[Male]

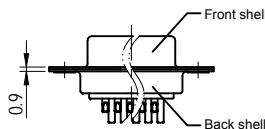
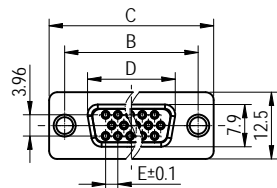
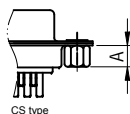
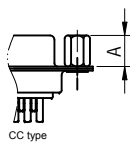
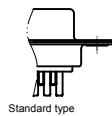
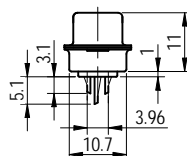
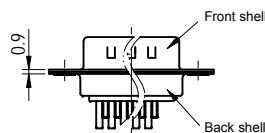
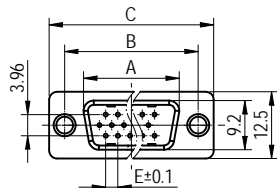

Dimension

Position	A±0.2	B±0.2	C±0.3	D	E
15	17.90	24.99	30.80	16.33	2.29
26	26.50	33.32	39.14	24.66	2.29
44	40.00	47.04	53.04	38.38	2.29
62	56.50	63.50	69.32	54.84	2.14
78	54.30	61.00	67.04	52.34	2.14

NOTES:

- Electrical characteristics:
  - Contact resistance: 20mΩ Max. Initial.
  - Dielectric withstanding voltage: 500V AC(ms) for 1 minute.
  - Insulation resistance: 1000MΩ Min.
- Environment characteristics:
  - Temperature range: -40°C~+105°C.
- Materials
  - Insulator: Thermoplastic.
  - Contact: Copper alloy.
  - Shell: Steel.
  - Screw: Copper alloy.
- Product number code:
 

DG1035 - X X X X X X X X

  - Screw DIM. A
    - S: Standard(W/O nut)
    - 1: 3.00 2: 4.00
    - 3: 4.50 4: 5.00
    - 5: 5.50 6: 5.80
  - Screw type
    - S: Standard(W/O nut)
    - 1: CC type
    - 2: CS type
  - Contact plating
    - 8: Full gold flash
    - Si: Selective gold flash
  - Shell plating
    - T: Front & Back shell tin
    - N: Front shell nickel, Back shell tin
  - Housing color
    - B: Black
    - W: White
    - U: Blue
  - Connector type
    - M: Male
    - F: Female
  - No. of contacts
    - 15: 15pos. 26: 26pos.
    - 44: 44pos. 62: 62pos.
    - 78: 78pos.

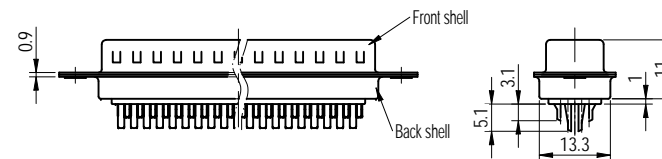
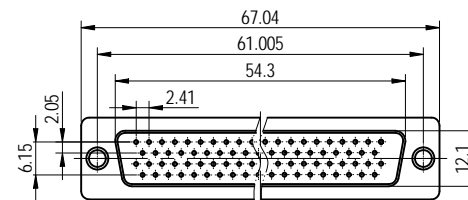
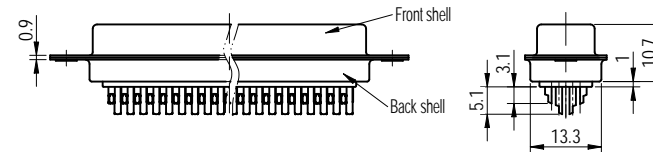
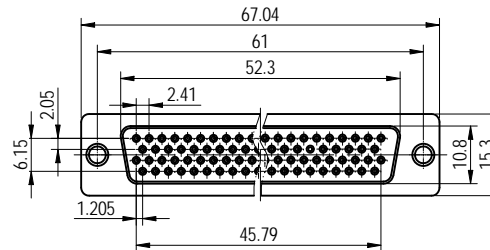

(Series Image-Reference Only)

GENERAL TOLERANCE		DEGSON	MATERIAL:		SURFACE/COLOR:	
X	+0.60		APPD: 兰春华	2023.07.31	MAT NO./REV:	/ 00
X	+0.38	CHKD: 陈超	2023.07.31	NAME: DG1035-XXXXXXX		
XX	+0.25	DRFT: 唐本恒	2023.07.28	DRAWING NO.	200035040	TYPE: CUSTOMER DRAWING
REV	ECN	DESCRIPTION	DRFT	DATE	DRAWING STATUS	SCALE
00			唐本恒	2023.07.28	已发布	2:1
						SHEET 1/1

Disclaimer: This document is for reference only. All rights reserved for patent. 此文件仅供参考。所有权利保留。如有侵权，请联系删除。